

USER GUIDE

JAWBONE
ERA™

ENGLISH/ESPAÑOL

CONTENTS

	JAWBONE ERA ANATOMY	PAGE 4
	POWER UP	8
1	GET COMFORTABLE	10
2	GET CONNECTED	13
3	GET TALKING & MORE	16
4	GET APPS & UPDATES	21
	SPECS & CHEAT SHEET	24
	SAFETY INFORMATION	26



WATCH TUTORIAL VIDEOS AT
JAWBONE.COM/ERA/VIDEOS

JAWBONE ERA ANATOMY

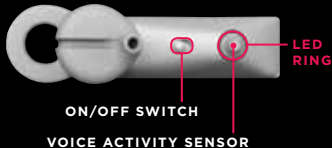
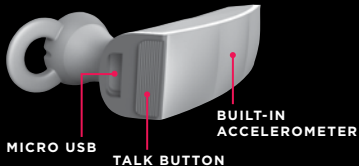

IF THE **LED RING** IS...



FLASHING WHITE

Jawbone ERA™ is trying to connect to your phone.



FLASHING RED

Battery is low. Power up!



FLASHING RED + WHITE

Jawbone ERA™ is in pairing mode and ready to connect to your phone. Go to your phone's Bluetooth® settings to connect.

MOTION GLOSSARY



TAPTAP*

Tap the outer surface of your headset 2 times to answer, end & switch between calls.

2X or 4X



SHAKESHAKE*

Shake your headset 2 times to answer incoming calls when it's not in your ear.

DOUBLE SHAKESHAKE*

Shake your headset 4 times to activate pairing mode. The LED will flash red & white.

POWER UP

Your Jawbone ERA™ is partially charged and ready to use right out of the box.

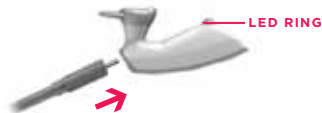

FOR A FULL CHARGE

Plug your headset into the wall charger or a USB port on your computer.

TO HEAR REMAINING BATTERY LIFE

Press the **TALK BUTTON** when not on a call. When fully charged, the LED RING will turn white.

WHEN BATTERY IS LOW

The **LED RING** flashes **RED**.

NOTE It only takes 30 minutes to get your headset 80% charged. A full charge takes 60 minutes.

BATTERY METER ON YOUR PHONE

IPHONE* Shows up automatically when connected

OTHERS Go to **MYTALK.JAWBONE.COM**

1 GET COMFORTABLE

1.1 FIND YOUR FIT

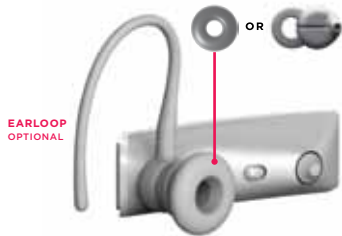

Mix and match earbuds with the optional earloop to find the most comfortable and secure option for you.

1.2 DROP, TWIST & POINT

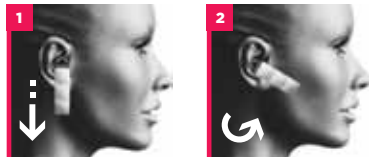

- 1 For the most secure fit, place your Jawbone ERA™ in your ear pointing down.
- 2 Then twist it upwards so it points directly at your mouth.

1.3 ENSURE BEST QUALITY

VOICE ACTIVITY SENSOR



Your headset works regardless of position, but you will get the best performance if the Voice Activity Sensor physically touches your cheek and points directly at your mouth.

 Watch video tutorials at [JAWBONE.COM/FIT](https://www.jawbone.com/fit)

2 GET CONNECTED

2.1 PREPARE YOUR HEADSET

To activate pairing mode, Double ShakeShake® your headset (shake 4 times).

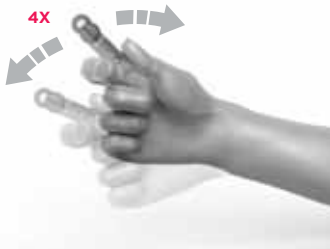

2.2 PREPARE YOUR PHONE

To turn on Bluetooth®.

ON AN IPHONE®

Go to **SETTINGS > GENERAL > BLUETOOTH** and enable **BLUETOOTH**

ON A BLACKBERRY®

Go to **SETTINGS/OPTIONS > BLUETOOTH** and enable **BLUETOOTH**

ON AN ANDROID™ PHONE

Go to **SETTINGS > WIRELESS & NETWORK > BLUETOOTH SETTINGS** and enable **BLUETOOTH**

OTHER CELL PHONES

Go to **JAWBONE.COM/PAIRING** or review the instruction manual that came with your phone.

2.3 MAKE THE CONNECTION

Go to your phone's Bluetooth® settings.

ADD, SEARCH OR SCAN FOR DEVICES

When "Jawbone ERA" appears, select it.

IF ASKED FOR A PASSCODE

Enter "0000"

NOTE This is a one-time event per phone. To pair Jawbone ERA™ to another phone, repeat steps 2.1 to 2.3.

3 GET TALKING & MORE

3.1 ANSWER/END A CALL

Jawbone ERA™ offers several ways to answer and end a phone call.



TAPTAP*

TAP the outer surface of your headset 2 times.

TALK BUTTON

Press the **TALK BUTTON**.



3.2 DECLINE AN INCOMING CALL

PRESS and **HOLD** the **TALK BUTTON** for 2 seconds.

3.3 MAKE A CALL

Use your phone to dial as usual. Listen and talk through your headset.

ACTIVATE DIAL APP / VOICE DIAL

Hold the **TALK BUTTON** until you hear a beep, then release and follow the voice prompts. Voice Dial is pre-loaded.

REDIAL LAST NUMBER

Press the **TALK BUTTON** 2 times to redial the last number you called.

3.4 SIMULTANEOUS CALLS

To switch between calls, **TAP** 2 times or press the **TALK BUTTON**. To end one call and switch to the other, press the **TALK BUTTON** 2 times. With Simultaneous Multipoint, you can even switch between calls from two different phones.

3.5 AUTOMATIC VOLUME CONTROL

NoiseAssassin® 3.0 intelligently adjusts incoming call volume to your surroundings so that you can hear better. Volume will automatically increase when you enter a noisy place and decrease when you enter a quiet place.

3.6 ADJUST THE VOLUME

Use the volume control on your phone. Or, while on a call or listening to music, **PRESS** and **HOLD** the **TALK BUTTON** and the volume level will cycle up and down. When you find the most comfortable volume level, release the button and your volume will be set.

3.7 STREAM AUDIO WITH A2DP

Listen to music, video, turn-by-turn directions and other audio streamed directly to your ear from any A2DP-enabled Bluetooth® device.

4 GET APPS & UPDATES

Jawbone® **MYTALK** lets you personalize and update your Jawbone ERA™ via the web.



Visit **MYTALK.JAWBONE.COM**

PERSONALIZE YOUR JAWBONE ERA™

AUDIO APPS

Change the voice that tells you information such as battery life and caller ID.

DIAL APPS

Customize the **TALK BUTTON** to speed dial your favorite number, or link directly to 411, voice-to-text, and other voice services.

To access DialApps on your headset, **PRESS** and **HOLD** the **TALK BUTTON**, then follow the voice prompts.

CALLER ID WITH NAMES

Hear caller ID with names by programming your **MYTALK** address book and syncing with your headset.

WIDEBAND AUDIO

Jawbone ERA™ delivers high-definition audio via wideband speaker. Your music, video and calls have never sounded better.

SOFTWARE UPDATES

Update Jawbone ERA™ with the latest software by signing into **MYTALK.JAWBONE.COM**

EXTRAS

Did you know that Jawbone ERA™ lets you get more out of the apps you already love? Watch videos in private, play games without annoying the people around you, even listen to sports on the go and without anyone knowing that you're streaming audio.

We've assembled a list of some cool 3rd party apps and services that get even better when you're wireless and hands free.

To learn more, sign into **MYTALK.JAWBONE.COM** and click the **EXTRAS** tab.

SPECS & CHEAT SHEET

SPECIFICATIONS

TALK TIME Up to 5.5 hours

STANDBY TIME Up to 10 days

CHARGING 30 minutes (80%); 60 Minutes (full)

WIRELESS RANGE 33ft (10m)

BLUETOOTH® 2.1 +EDR, HSP 1.1, HFP 1.5, A2DP 1.2

CONNECTIONS Supports up to 8 paired devices and 2 active connections with Multipoint

WEIGHT 10.2 grams

DIMENSIONS 51.29mm X 14.49mm X 24.10 mm (LxWxD)

CHEAT SHEET

ACTION

ACTIVATE PAIRING MODE*

ANSWER CALL

END CALL

SWITCH BETWEEN CALLS

END CALL &
ANSWER INCOMING

ADJUST VOLUME

ACTIVATE VOICEDIAL/
DIALAPPS*

REDIAL LAST NUMBER*

HEAR BATTERY STATUS*

HEADSET CONTROL

Double ShakeShake*

TapTap* or Press TALK Button

TapTap* or Press TALK Button

TapTap* or Press TALK Button

Press TALK Button 2X

Hold TALK Button or
adjust on your phone

Hold TALK Button

Press TALK Button 2X

Press TALK Button

*not during a call

SAFETY INFORMATION

WARNING

Failure to follow these safety instructions could result in hearing damage or in fire, electric shock, or other injury or damage.

Avoiding Hearing Damage

Permanent hearing loss may occur if the Jawbone® headset is used at a high volume. Set the volume to a safe level. Even though you may become accustomed to a higher volume of sound, and even though it may sound normal, any higher volume of sound can be damaging to your hearing. If you experience ringing in your ears or muffled speech, stop listening and have your hearing checked. The louder the volume, the less time is required before your hearing could be affected. The Jawbone® headset has been initially set at a medium volume for sound. Do not increase the level of volume unless you are in conditions where you need a higher level for a short period of time. If this level of volume is uncomfortably high for you, you should decrease this level.

HEARING EXPERTS SUGGEST THAT TO PROTECT YOUR HEARING:

- 1 Limit the amount of time you use the Jawbone® headset including use at high volume.
- 2 Avoid turning up the volume to block out noisy surroundings.
- 3 Turn the volume down if you can't hear people speaking near you.

Jawbone Headset Care

- Do not expose your Jawbone® headset to liquid, moisture, humidity, or rain. The Jawbone® headset is not waterproof.
- Do not tamper with or abuse the Jawbone® headset. For example, without limitation, do not drop, disassemble, open, crush, bend, deform, puncture, shred, microwave, incinerate, paint, or insert foreign objects into the Jawbone® headset.
- Do not use abrasive cleaners to clean your Jawbone® headset.
- Do not expose your Jawbone® headset to extremely high or low temperatures.
- Do not leave your Jawbone® headset in direct sunlight for an extended period of time.
- Do not leave your Jawbone® headset near open flames such as cooking burners.
- Do not dispose of your Jawbone® headset in a fire. The battery could explode.
- Do not bring your Jawbone® headset into contact with any sharp objects. This can cause scratches and damage.
- Do not insert anything into your Jawbone® headset unless otherwise specified in the user manual. This may damage the internal components.
- Do not attempt to disassemble your Jawbone® headset, it does not contain serviceable components.
- Do not wear your Jawbone® headset without a Jawbone® approved earbud.

Built-in Battery Care

- Do not attempt to replace your Jawbone® headset's battery. It is built-in and not changeable.
- Charge the battery in accordance with the instructions supplied with this guide.
- Use only the charger supplied by Jawbone® headset's original manufacturer to charge the battery.

Charger Care

- Use only the charger supplied by the Jawbone® headset's original manufacturer to charge your Jawbone® headset. Other chargers may look similar but using them could be dangerous and could damage the Jawbone® headset.
- Do not attempt to disassemble the charger as it may expose you to dangerous electric shock.
- Do not use the charger outdoors or in damp areas.
- Only charge your Jawbone® headset's built-in battery in accordance with the instructions described in this guide.
- Avoid charging your Jawbone® headset in extremely high or low temperatures.
- Do not use your Jawbone® headset while it is charging.
- Do not connect the Jawbone® headset to the charger while on an active call.

Safety Information

- Check and observe local laws regarding the use of a mobile phone and headset while driving. If you use the Jawbone® headset while driving, ensure that you maintain your full attention and focus; it is your responsibility to drive safely. Consider pulling off the road before making or answering a call.
- Never allow children to play with the Jawbone® headset; the small components of the headset may be a choking hazard.
- Do not leave or store the Jawbone® headset or any of its accessories in the area over the air bag or in the air bag deployment area of an automobile as serious injury may result when an air bag deploys.
- Observe all signs and displays that require an electrical device or RF radio product to be switched off in designated areas.
- Turn off your Jawbone® headset prior to boarding aircraft. Do not use the Jawbone® headset inside an aircraft in flight unless allowed by your airline.
- Never use the Jawbone® headset while taking a bath.
- Do not use the Jawbone® headset in a sauna or steam room.
- Do not keep your Jawbone® headset near a sink or other wet areas.

- Do not clean your Jawbone® headset while it is being charged. Always unplug the charger first before cleaning the Jawbone® headset.
- Do not attempt to repair or modify the Jawbone® headset yourself. The Jawbone® headset does not contain any user-serviceable parts. If the Jawbone® headset has been submerged in water, punctured, or subjected to a severe fall, do not use it until you take it back to your original place of purchase.
- Do not attempt to force open the built-in battery.
- Dispose of the battery in the Jawbone® headset according to local regulations. Do not dispose of the battery with household waste.
- Disposal of the packaging and your Jawbone® headset should be done in accordance with local regulations.
- Please only use with the power supply adapter provided, Jawbone® model number **SPA-K901**.
- Please only use the supplied USB cable to charge the Jawbone® headset, Jawbone® model number **JBGDMUSB-CC**.

Other Notes

PACKAGING AND PRODUCT DISPOSAL Dispose of the packaging and this product in accordance with the latest provisions.

IC RSS-GEN This device complies with RSS 210 of Industry Canada. Operation is subject to the following two conditions:

- 1 This device may not cause interference, and
- 2 This device must accept any interference, including interference that may cause undesired operation of the device.

FCC NOTICE This device complies with Part 15 of the FCC Rules. Operation is subject to the following two conditions:

- 1 This device may not cause harmful interference, and
- 2 This device must accept any interference received, including interference that may cause undesired operation.

CAUTIONS

- Any changes or modifications not expressly approved by the party responsible for compliance could void the user's authority to operate this equipment.
- This device and its antenna(s) must not be co-located or operating in conjunction with any other antenna or transmitter.

FCC ID: V3J-JBF. IC: 7589A-JBF.

To locate the FCC and IC identification numbers, please remove the earbud from the Jawbone headset.

GET MORE HELP (IF YOU NEED IT)



VISIT JAWBONE.COM/SUPPORT
for video tutorials



CALL 1-877-254-7426



GO TO JAWBONE.COM/WARRANTY
for warranty info



PURCHASE the official Jawbone Cable Kit, Jawbone ERA™ Fit Kit and other accessories at WWW.JAWBONE.COM



FOLLOW us on Facebook® & Twitter®
JAWBONE.COM/FACEBOOK



JAWBONE.COM/TWITTER



This product is compliant with the CE directive.

All returns must be made to the original place of purchase.

Powered by MotionX™. US and foreign patents granted and pending. TapTap® and ShakeShake® are registered trademarks of Fullpower Technologies, Inc. ©Copyright 2003-2010 Fullpower Technologies, Inc. All rights reserved. iPhone® is a registered trademark of Apple Inc. BlackBerry® is a registered trademark of Research In Motion Limited. Android is a trademark of Google Inc. Use of this trademark is subject to Google Permissions www.google.com/permissions/index.html

©2010 JAWBONE. ALL RIGHTS RESERVED. 770-00326 REV A