



USER'S GUIDE  
V:1749-0412-11



# ISD291B

## Speaker Dock for iPod, iPhone, and iPad

For the most up-to-date version of this User's Guide, go to [www.ilive.net](http://www.ilive.net)

# Warnings and Precautions

- **CAUTION:** TO PREVENT ELECTRIC SHOCK, MATCH WIDE BLADE OF PLUG TO WIDE SLOT, FULLY INSERT.
- **WARNING:** To reduce the risk of fire or electric shock, do not expose this apparatus to rain or moisture.
- **AVERTISSEMENT:** Pour réduire le risque d'incendie ou de choc électrique, ne pas exposer cet appareil sous la pluie et l'humidité.
- **CAUTION:** Use of any controls or adjustments or performance of procedures other than those herein specified may result in hazardous radiation exposure.
- **WARNING:** Changes or modifications to this unit not expressly approved by the party responsible for compliance could void the user's authority to operate the equipment.
- **WARNING:** Do not place the unit on top of any soft, porous, or sensitive surfaces to avoid damaging the surface. Use a protective barrier between the unit and surface to protect the surface.
- **WARNING:** Use of this unit near fluorescent lighting may cause interference regarding use of the remote. If the unit is displaying erratic behavior move away from any fluorescent lighting, as it may be the cause.
- **CAUTION:** Danger of explosion if battery is incorrectly replaced. Replace only with the same or equivalent type.
- **PRÉCAUTION:** *Danger d'explosion si les piles sont remplacées de façon incorrect. Remplacer les piles seulement par le même type de pile ou l'équivalent.*
- **WARNING:** There is a danger of explosion if you attempt to charge standard Alkaline batteries in the unit. Only use rechargeable NiMH batteries.
- **WARNING:** The battery, batteries, and battery pack shall not be exposed to excessive heat such as sunshine, fire, or the like.

- **WARNING:** Lithium batteries, like all rechargeable batteries are recyclable and should be recycled or disposed of in normal household waste. Contact your local government for disposal or recycling practices in your area. They should never be incinerated since they might explode.
- **WARNING:** Shock hazard - Do Not Open.
- **AVIS:** *RISQUE DE CHOC ÉLECTRIQUE - NE PAS OUVRIR*

Mains Plug or Direct plug-in adapter is used as disconnect device and it should remain readily operable during intended use. In order to disconnect the apparatus from the mains completely, the Mains Plug or Direct plug-in adapter should be disconnected from the mains socket outlet completely.

*La fiche d'alimentation ou adaptateur de courant est utilisé comme dispositif de déconnexion et doit rester accessible pendant l'utilisation. Pour mettre l'appareil hors tension, la fiche ou adaptateur de courant doit être débranché de la prise de courant.*

Do not mix old and new batteries.  
Do not mix alkaline, standard (carbon-zinc), or rechargeable (ni-cad, ni-mh, etc) batteries.  
*No mezcle baterías viejas y nuevas.  
No mezcle baterías alcalinas, estándar (carbón-zinc) o recargables (ni-cad, ni-mh, etc.).*



**WARNING:** TO REDUCE THE RISK OF ELECTRIC SHOCK, DO NOT REMOVE COVER (OR BACK). NO USER-SERVICEABLE PARTS INSIDE. REFER SERVICING TO QUALIFIED SERVICE PERSONNEL.



The lightning flash with arrowhead symbol, within an equilateral triangle, is intended to alert the user to the presence of uninsulated "dangerous voltage" within the product's enclosure that may be of sufficient magnitude to constitute a risk of electric shock to persons.



The exclamation point within an equilateral triangle is intended to alert the user to the presence of important operating and maintenance (servicing) instructions in the literature accompanying the appliance.

# Important Safety Instructions

1. Read these Instructions.
  2. Keep these Instructions.
  3. Heed all Warnings.
  4. Follow all instructions.
  5. Do not use this apparatus near water.
  6. Clean only with a dry cloth.
  7. Do not block any ventilation openings. Install in accordance with the manufacturer's instructions.
  8. Do not install near any heat sources such as radiators, heat registers, stoves, or other apparatus (including amplifiers) that produce heat.
  9. Do not defeat the safety purpose of the polarized or grounding - type plug. A polarized plug has two blades with one wider than the other. A grounding type plug has two blades and a third grounding prong. The wide blade or the third prong are provided for your safety. When the provided plug does not fit into your outlet, consult an electrician for replacement of the obsolete outlet.
  10. Protect the power cord from being walked on or pinched particularly at plugs, convenience receptacles, and the point where they exit from the apparatus.
  11. Only use attachments/accessories specified by the manufacturer.
- 
12.  Use only with a cart, stand, tripod, bracket, or table specified by the manufacturer, or sold with the apparatus. When a cart is used, use caution when moving the cart/apparatus combination to avoid injury from tip-over.
- 
13. Unplug this apparatus during lightning storms or when unused for long periods of time.
  14. Refer all servicing to qualified service personnel. Servicing is required when the apparatus has been damaged in any way, such as power-supply cord or plug is damaged, liquid has been spilled or objects have fallen into the apparatus, the apparatus has been exposed to rain or moisture, does not operate normally, or has been dropped.
- 

**Special note:** When placing your unit on a lacquered or natural finish, protect your furniture with a cloth or other protective material.

## FCC Warnings

**WARNING:** Changes or modifications to this unit not expressly approved by the party responsible for compliance could void the user's authority to operate the equipment.

**NOTE:** This equipment has been tested and found to comply with the limits for a Class B digital device, pursuant to Part 15 of the FCC Rules. These limits are designed to provide reasonable protection against harmful interference in a residential installation. This equipment generates, uses, and can radiate radio frequency energy and, if not installed and used in accordance with the instructions, may cause harmful interference to radio communications. However, there is no guarantee that interference will not occur in a particular installation. If this equipment does cause harmful interference to radio or television reception, which can be determined by turning the equipment off and on, the user is encouraged to try to correct the interference by one or more of the following measures:

- Reorient or relocate the receiving antenna.
- Increase the separation between the equipment and receiver.
- Connect the equipment into an outlet on a circuit different from that to which the receiver is connected.
- Consult the dealer or an experienced radio/TV technician for help.

## Additional Warnings

- The apparatus shall not be exposed to dripping or splashing and that no objects filled with liquids, such as vases, shall be placed on apparatus.  
*L'appareil ne doit pas être exposé aux écoulements ou aux éclaboussures et aucun objet ne contenant de liquide, tel qu'un vase, ne doit être placé sur l'objet.*
- Battery shall not be exposed to excessive heat such as sunshine, fire or the like.  
*Les piles ne doivent pas être exposées à de forte chaleur, tel qu'à la lumière du soleil, au feu ou autres choses de semblable.*
- Caution marking is located at the rear or bottom of the apparatus.  
*Attention marquage est situé sur le panneau arrière ou inférieur de l'unité.*
- The marking information is located at the rear or bottom of apparatus.  
*Le marquage est situé sur le panneau arrière ou inférieur de l'unité.*



This symbol indicates that this product incorporates double insulation between hazardous mains voltage and user accessible parts.

## Speaker Dock for iPod, iPhone, and iPad

### Features

- Made for iPod, iPhone, and iPad
- Plays and charges docked iPod, iPhone, and iPad
- Rotating dock for iPod, iPhone, and iPad
- Composite video output
- 3.5mm audio input
- Dynamic stereo speakers

### Included

- iPad Support
- 2 rubber spacers for iPad
- AC/DC power adapter

## Table of Contents

<b>Speaker Dock for iPod, iPhone, and iPad</b> .....	<b>4</b>
Features	
Included	
<b>Table of Contents</b> .....	<b>5</b>
<b>Introduction</b> .....	<b>6</b>
<b>Setup</b> .....	<b>8</b>
Power	
Speaker Dock Position Map	
<b>iPod, iPhone, and iPad</b> .....	<b>9</b>
Docking an iPod or iPhone	
Docking an iPad	
Playing a Docked iPod, iPhone, or iPad	
<b>Video Output</b> .....	<b>10</b>
Using the Composite Video Output	
<b>3.5mm Audio Input</b> .....	<b>11</b>
Using the 3.5mm Audio Input	
<b>Company Information</b> .....	<b>12</b>
International Support	
Contact Information	
Green Initiative	

## Introduction

### Power/Play/Pause

Press to turn the speaker dock on. When powered on, press to play and pause a docked iPhone or iPad. Press and hold to power off.

**Power Indicator Light**

**Dock for iPod, iPhone, and iPad**

**Volume**  
Press to adjust the volume.

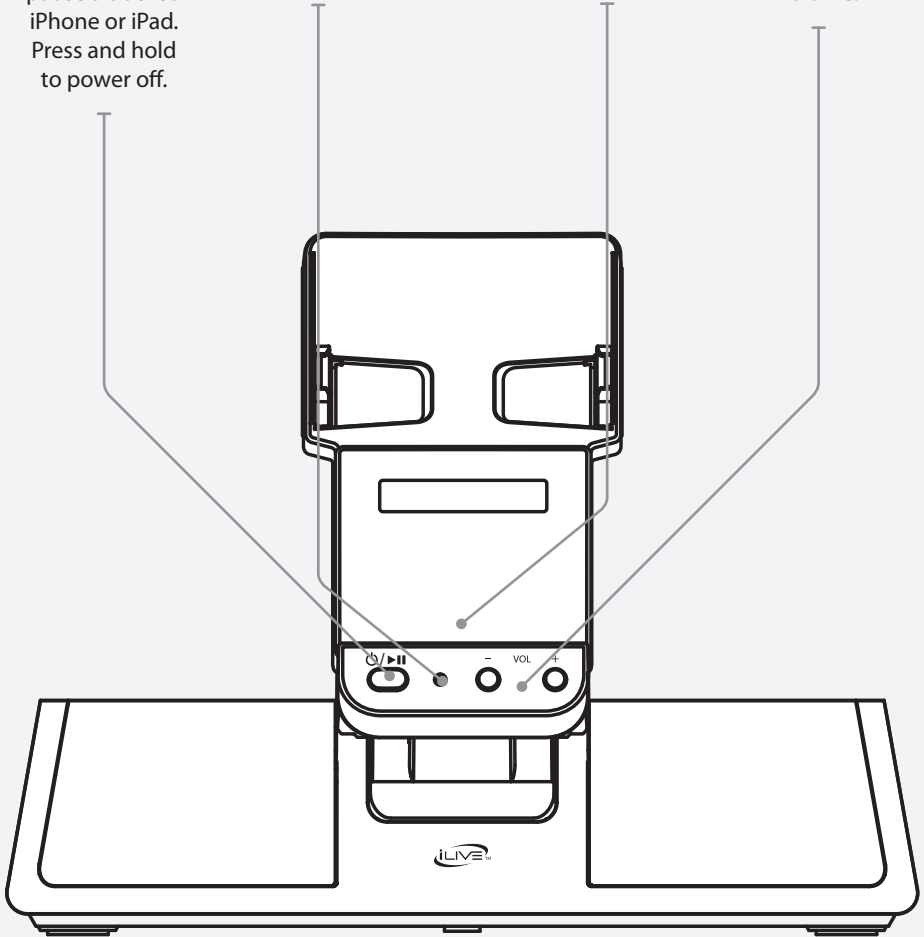

**Composite Video Output**

**Video On/Off**  
Press to turn the video output off and on.

**DC Power Input**

**3.5mm Audio Input**

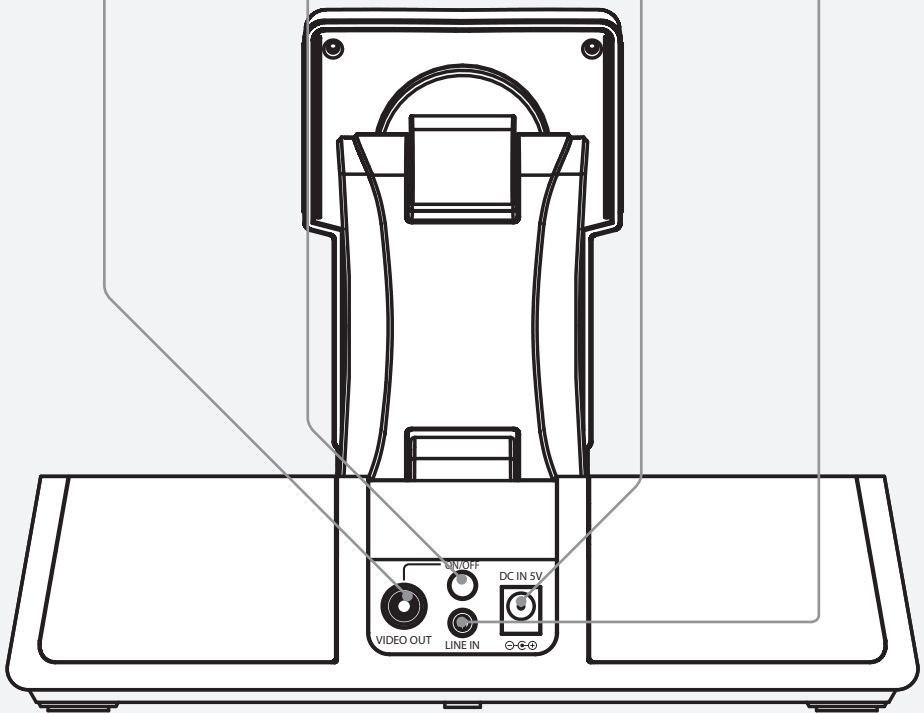

## Setup

### Power

DC power input: requires an AC/DC power adapter (included)

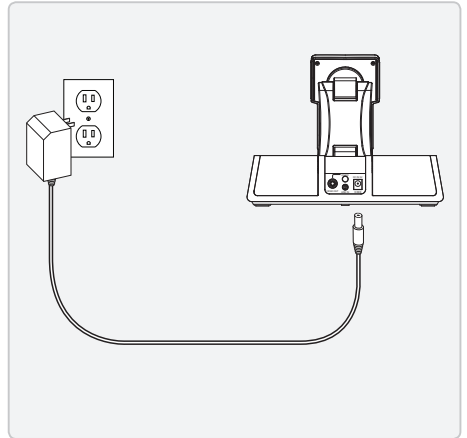

### Speaker Dock Position Map

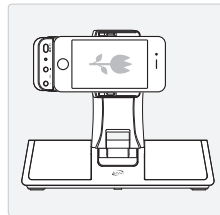
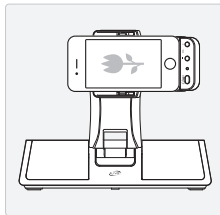
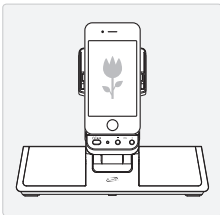
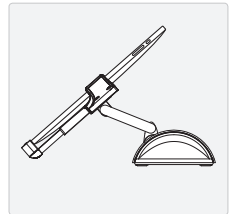
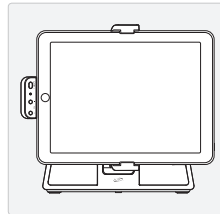
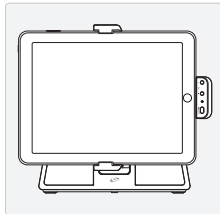
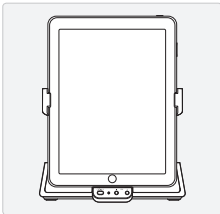



## iPod, iPhone, and iPad

### Docking an iPod or iPhone

1. Open the side support hinges. (*figure 9-1*)
2. Connect the iPod or iPhone to the connector inside the Dock for iPod and iPhone.
3. When the speaker dock is plugged in, using AC power, the docked iPod or iPhone will charge.

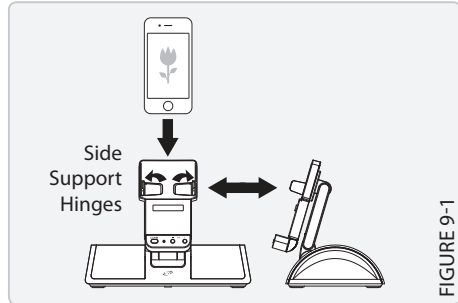

### Docking an iPad

1. Close the side support hinges on the speaker dock. (*figure 9-2*)
2. Slide the iPad support into place on the speaker dock. (*figure 9-2*)
3. Attach the included rubber spacers as needed to properly support the iPad being docked.
4. Extend the Dock for iPad. (*figure 9-3*)
5. Connect the iPad to the connector inside the Dock for iPad. (*figure 9-4*)
6. When the speaker dock is plugged in, using AC power, the docked iPad will charge.

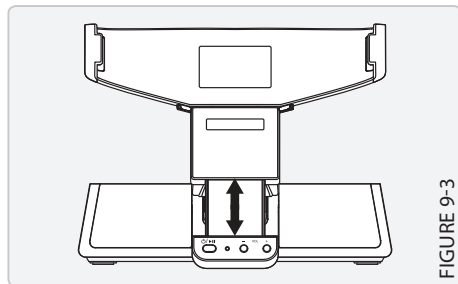
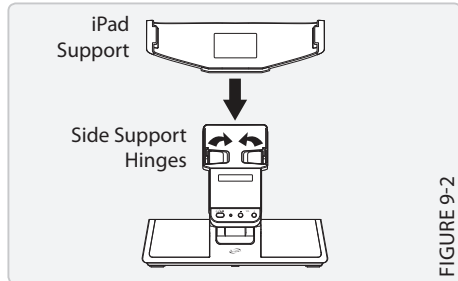

### Playing a Docked iPod, iPhone, or iPad

1. Follow the instructions for [Docking an iPod, iPhone, or iPad](#).
2. Press the **Power** button to power the speaker dock on.
3. Use the native controls on the docked iPod, iPhone, or iPad to play and control music through the speaker dock.
4. Use the **Volume** buttons on the speaker dock to adjust the volume.

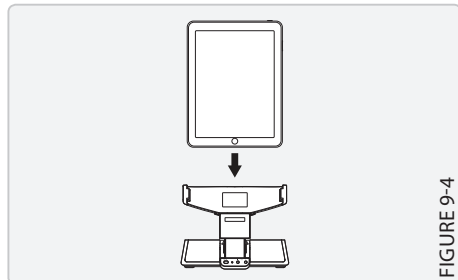

## Video Output

### Using the Composite Video Output

Requires an RCA composite video cable (not included)

1. Connect the RCA composite video cable to the **Composite Video Output** on the speaker dock and a composite video input on a television.
2. Press the **Video On/Off** button on the back of the speaker dock to turn the video output on.

*The video button is needed only when docking an iPod touch, iPhone, or iPad. When docking any other iPod, use the TV Out settings on the iPod to activate or deactivate the video output.*

*The default setting for the video output is Off.*

3. Videos played from the docked iPod, iPhone, or iPad will now play on the connected television.

## 3.5mm Audio Input

### Using the 3.5mm Audio Input

Requires a 3.5mm audio cable  
(not included)

1. Connect a 3.5mm audio cable to the **3.5mm Audio Input** on the speaker dock and an audio output on an MP3 player or other audio source.
2. When the 3.5mm audio cable is connected, the speaker dock will automatically switch to Line In mode.

*Disconnect the 3.5mm audio cable to switch from Line In mode to iPod, iPhone, and iPad mode.*

3. Use the native controls on the connected MP3 player or other audio source to play and control audio played through the speaker dock.

## Company Information

### International Support

To download this User's Guide in English, Spanish, or French, visit the support section at [www.ilive.net](http://www.ilive.net).

Para transferir esta guía de usuario en inglés, español, o francés, visite la sección de la ayuda en [www.ilive.net](http://www.ilive.net).

Pour télécharger ce guide de l'utilisateur en anglais, espagnol, ou français, visitez la section de soutien chez [www.ilive.net](http://www.ilive.net).

### Contact Information

**Phone:** 1-888-999-4215

**Email:** [customerservice@ilive.net](mailto:customerservice@ilive.net)

**Parts Email:** [partsinfo@dpi-global.com](mailto:partsinfo@dpi-global.com)

**Website:** [www.ilive.net](http://www.ilive.net)

### Green Initiative



Environmental Commitment to 'Protect for Today and Sustain for Tomorrow'

2009 marked the official launch of DPI, Inc.'s corporate campaign for a greener and cleaner world. DPI is building upon environmental initiatives introduced at all of their facilities to help formulate and sustain significant and important conservation efforts within its manufacturing and marketing communities. In addition to targeting and selecting energy efficient product features, and structuring 'green office' procedures, other initial program efforts include:

- Reduction of all packaging sizes
- Recyclable plastics for clamshell packages, with a plan to eventually replace plastic with recyclable paper
- Recycled fiber board in place of the polyfoam in packing boxes
- Recycled plastics in place of the virgin material in product construction