

**Item No. 541372 - Holder with Tilt Swivel and Spring Lock**



**Compatible with:**

ZTE Optik



**Warnings:**

Carefully read all instructions and review the images before attaching.

The ProClip mount and/or holder in the installation pictures may look slightly different from the one you have received. However, the same instructions apply. If you have questions call our customer service at **1-800-296-3212** or **+1-847-388-7171**.

ProClip USA, Inc. may not be held liable for any personal injury or damage to a vehicle or device, resulting from accident or improper use or installation, before, during or after the installation or removal of this mount and/or holder.



1. Unscrew the screw in the center of the holder so you can remove the tilt swivel base plate on the back. Place the tilt swivel base plate over the matching holes in the face plate of your mounting bracket (ProClip headrest mount shown in picture) Attach the base plate by using the self-tapping screws enclosed. Place the Holder onto the tilt swivel base plate and attach it with the center screw. This screw also controls the pivot, tighter for a firm hold and loose for more (easier) angling/rotation of the Holder.

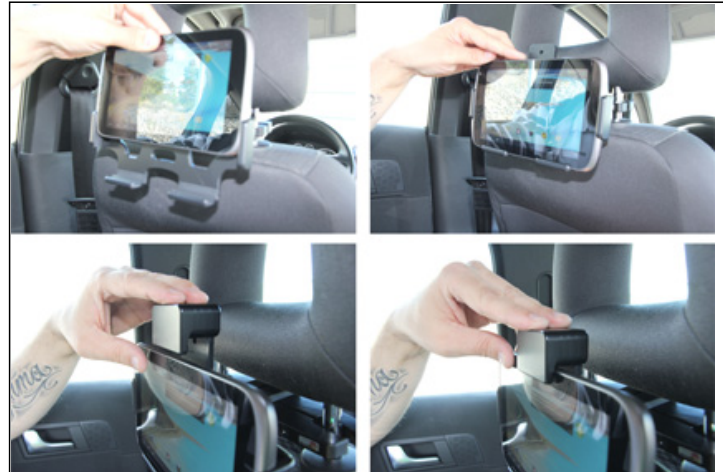

2. To insert the tablet into the holder: Slide the tablet carefully into the holder. Slide the spring lock onto the top part of the holder. Push until it clicks into place.



3. To remove the tablet from the holder: Pull firmly on the spring lock so it releases and pull it away from the holder. Slide the tablet carefully out of the holder.



4. The holder and tablet is in place. Switch between portrait and landscape view by rotating the holder to desired position.