

iDEN Mo Talk

EN

Index

Introductory information	2
1. General	2
2. Security guidelines	3
Installation of the hands-free car kit	5
3. Scope of supply	5
4. Positioning and mounting	6
5. Connecting the Electronic box	7
6. Functions of the keys on the remote control	8
Further Information	9
7. Service	9

1. General

Dear customer,

Congratulation on purchasing a BURY hands-free car kit. You have chosen a high quality product that is extremely easy to use. All aspects of BURY production through to sales and service are subject to strict quality management according to DIN EN ISO 9001. All BURY hands-free car kits meet CE and e1 security standards. Furthermore, we provide a two-year warranty on all components.

Please read the operating manual carefully so that you can fully enjoy your BURY hands-free car kit. If you have any further questions concerning installation or operation of your car kit, please contact your dealer. He will be happy to give you reliable advice. You can also contact our hotline. Our phone and fax numbers are listed in the chapter Service at the end of the operating instructions.

Have a good trip!

2. Security guidelines

Installation – who and where

The installation of this system can be carried out by yourself but please observe the installation requirements of the automotive manufacturer (VAS 1978). During the installation, park the car at a place where the road traffic is not impaired. We recommend to let a specialised workshop perform the installation.



Power supply

This system has been designed for the use in vehicles with an on-board supply system of 12 volts (passenger car). If you intend to install the device in a vehicle with an on-board supply system of 24 volts (lorry), please use a voltage converter. If you have queries regarding this subject, please contact our hotline.



Position, volume

Install the components of the device in the vehicle so that your field of vision is not impaired and the components are not mounted in the impact zone of the passenger compartment or in the airbag inflation zones. The removal of coverings (with and without airbags) or components of the dashboard requires – in some cases – special tools and special knowledge.



Intended use

We shall not be liable for damages or malfunctions due to improper use of the navigation system. Therefore, do not expose the device to moisture, extreme temperatures or shocks and carefully follow the procedure described in the installation and operating guidelines.



Use while driving

Operate the system only when the situation allows it and when you do not endanger, harm, constrain, or annoy other road users. The volume of the device has to be set in a way that exterior noise is still audible.

Faults

Do not commission the device if you detect or assume a defect. In this case, contact a Bury specialised dealer or our hotline. Improper repair efforts can be dangerous for you. Therefore, only skilled personnel may perform inspections.

Battery Charging

The charging process of the mobile phone battery starts after the connection of the mobile phone to the hands-free device. It ends when the mobile phone is disconnected.

Important:

- ▶ The driver is ultimately responsible for the safe operation and control of their vehicle at all times. You should never use a hand held phone, including sending or reading text or picture messages, while driving.
- ▶ Research indicates that there is a risk to safety when the driver of a motor vehicle is distracted and using a mobile phone while driving can be a distraction.
- ▶ The manufacturer strongly recommends that you use a hands-free solution when driving.

7. Service

In case of general or technical queries, suggestions and comments, please do not hesitate to contact our team at any time:

Point to Point Technology USA, Inc.

USA Sales, Support & Warranty - 1-888-807-4838

www.ptp-group.net

Suggestions and feedback are always welcomed.

6. Functions of the keys on the remote control

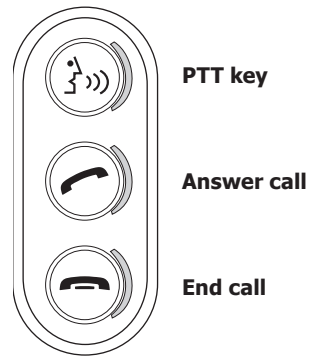
**Attention:**

► You can not use **End call** button to reject the incoming call. If this button will be pressed when phone is ringing, the call will be answered.

3. Scope of supply

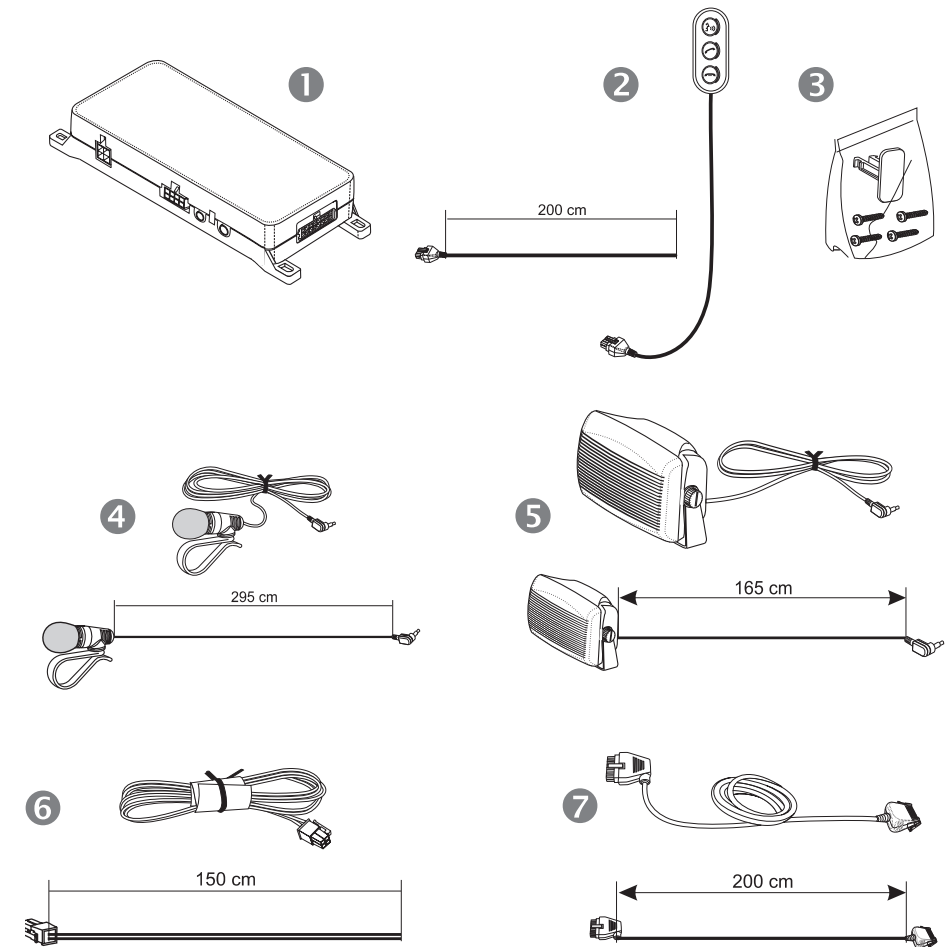
**Description of the components:**

- 1) Electronics box iDEN Mo Talk
- 2) Remote control
- 3) Fixing screws for electronics box
- 4) Microphone with cable
- 5) Loudspeaker with cable
- 6) Power supply cable
- 7) Phone cable

4. Positioning and mounting

Step 1:

Please first select the location which is most suitable for you in your car for the individual components.



Important:

► When placing and assembling the components, observe the information in the chapter: safety information.

Example of installation:

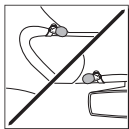
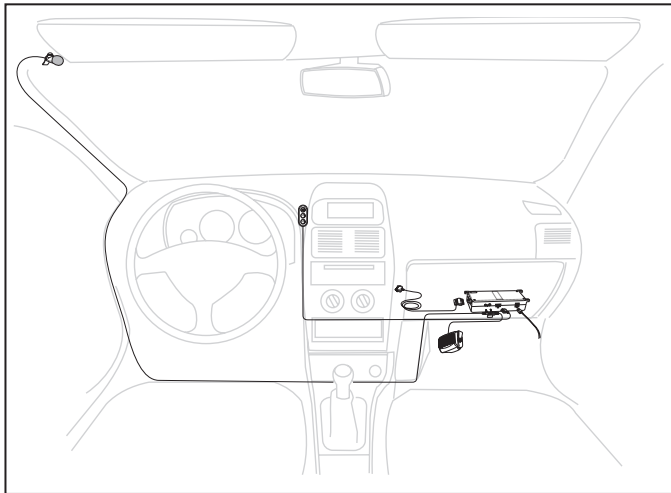

Step 2:

Depending on the vehicle type and its equipment (e.g. airbags), it is reasonable to install the microphone either at the A-pillar, at the sun shield or at the roof interior. For details about the equipment features please refer to the vehicle documents. Please also observe the notes on distances to other components and to the driver / speaker.

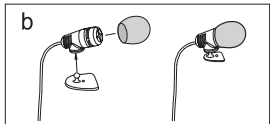
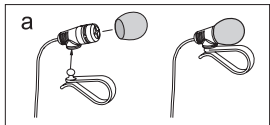

Step 3:

Please lay the cables in a way that they do not lie/hang unsecured in the vehicle and that they may not influence the conducting of the vehicle. When laying a cable, please take care that it is not under traction stress but that it has some tolerance. Avoid crushing the cable as damages of the insulation can be caused by friction/rubbing.

Step 4:

Install the electronics box at a convenient place in the vehicle. This can e.g. be behind the radio, in the glove box, or in the centre console. Please mind that you can access the connections of the box without difficulty. Before connecting the components to the electronics box you should branch off the battery for safety reasons. In doing so, take into account that there might be a radio coding (confer radio manual).

Important:

► Please install the electronics box behind a cover or somewhere you can only reach by opening or unfastening a protective cover/ a cover. The terminal box must not hang loosely in the vehicle.

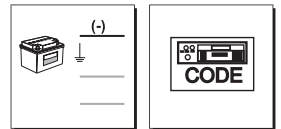
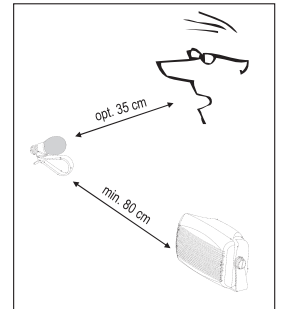

5. Connecting the Electronic box

The power supply of the hands-free car kit is established via a 2-core cable. Connect the black (clamp 31 – minus) and the red cable (clamp 30 – steady plus) to the power supply of your car. Please connect the white Molex connector with connection 1.

Attention:

► The hands-free car kit with connected phone will be permanently supplied with power. If the vehicle is not running for a longer period, this could lead to a discharge of the car battery.

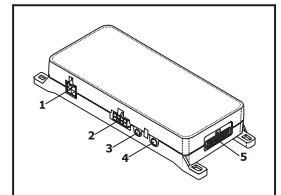

Plug the phone jack of the loud speaker output to connection 3, the phone jack of the microphone to connection 4 and connect the Molex plug of the remote control with socket 2.

Now place the slider between the microphone and the loud speaker box. This has the effect that the phone jack remains in its place in spite of possible vibrations when driving.

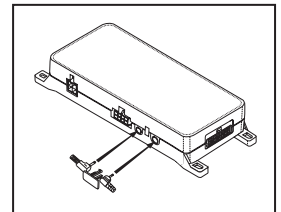

Now connect the Molex plug of the phone cable with socket 5